



SPARE PARTS EXPLODED VIEW
STORAGE ELECTRIC WATER HEATERS
Model
ABS ANDRIS LUX

R8217264-04 - 24/11/2025

ABS ANDRIS LUX

Storage Electric Water Heaters

1	3100604	ABS ANDRIS LUX 10 OR	08-2015	-
2	3100605	ABS ANDRIS LUX 10 UR	08-2015	-
3	3100606	ABS ANDRIS LUX 15 OR	08-2015	-
4	3100607	ABS ANDRIS LUX 15 UR	08-2015	-
5	3100608	ABS ANDRIS LUX 30	08-2015	-
Col	Reference	Model type	Begin	End

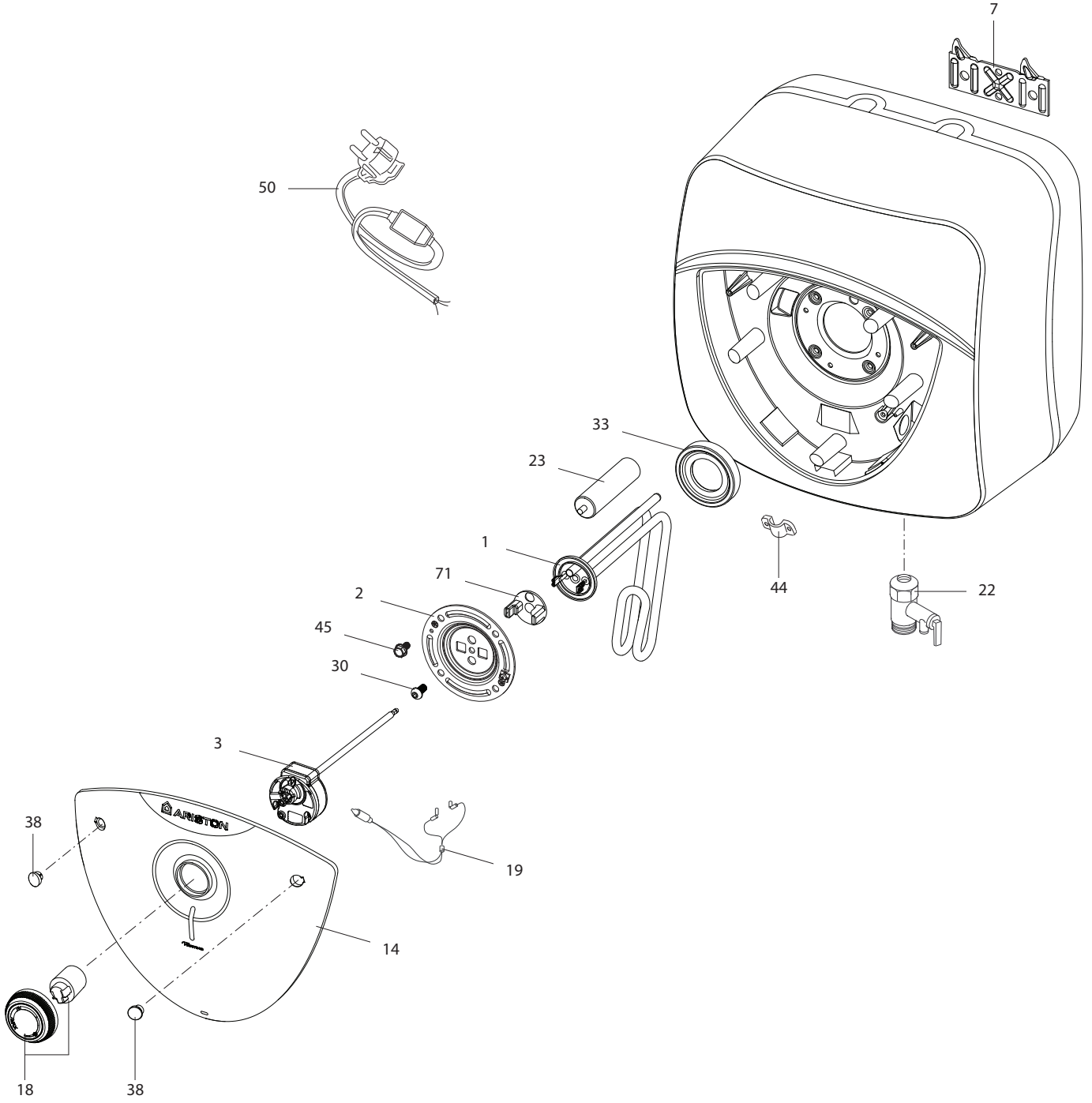

☉	Description	Manf. Pt. N	Type	<div style="display: flex; justify-content: space-between; align-items: center;"> <div style="writing-mode: vertical-rl; transform: rotate(180deg); font-size: 8px;"> A. ANDRIS LUX 10 OR A. ANDRIS LUX 10 UR A. ANDRIS LUX 15 OR A. ANDRIS LUX 15 UR A. ANDRIS LUX 30 </div> <div style="border: 1px solid black; padding: 2px; font-size: 10px;">31</div> </div>																		From	to
				1	2	3	4	5	6	7	8	9	10	11	12	13	14	15	16	17	18		
0001	HEATING ELEMENT 1200W 220-240V	6501198200				•	•													11/25			
	HEATING ELEMENT 1200W 220-240V	6501201000		•	•															11/25			
	HEATING ELEMENT 1200W 220-240V	65114900				•	•														10/25		
	HEATING ELEMENT 1200W 220-240V	65114905		•	•																10/25		
	HEATING ELEMENT 1500W 220-240V	6501198600								•										11/25			
	HEATING ELEMENT 1500W 220-240V	65114894								•											10/25		
0002	FLANGE (4 HOLES)	65114661		•	•	•	•	•	•												12/15		
	FLANGE (4 HOLES)	65115359		•	•	•	•	•	•											01/16			
0003	THERMOSTAT	65114891								•													
	THERMOSTAT	65114908		•																			
	THERMOSTAT	65115012			•																		
	THERMOSTAT	65115013				•																	
	THERMOSTAT	65115014						•															
0007	HEATER WALL HANGING BRACKET	570341		•	•	•	•	•	•														
0014	PLASTIC COVER (COMPLETE)	65115148								•													
	PLASTIC COVER (COMPLETE)	65119837		•	•	•	•	•	•														
0018	COMPLETE KNOB (REGULATION)	65115024		•	•	•	•	•	•														
0019	SIGNAL LAMP	65111550		•	•	•	•	•	•												05/24		
	SIGNAL LAMP	993025		•	•	•	•	•	•											06/24			
0022	SAFETY VALVE WITH LEVER (1/2" 8,5 BAR)	571730		•	•	•	•	•	•														
0023	ANODE D21,3 L:110 M5-M8	65103768-01		•	•	•	•	•	•												10/25		
	ANODE D21,3 L:110 M6	6501151200		•	•	•	•	•	•											11/25			
0030	SCREW M6X12	993000		•	•	•	•	•	•														
0033	FLANGE GASKET	65116115		•	•	•	•	•	•														
0038	SCREW COVER	65115133		•	•	•	•	•	•														
0044	CABLE CLAMP	573266		•	•	•	•	•	•														
0045	FLANGE SCREW M6X12	65114656		•	•	•	•	•	•														
0050	POWER CABLE WITH ELCB (16 A 1,5m)	65151908		•	•	•	•	•	•														
0071	TERMINAL SHIELD (GREEN)	65121494								•													
	TERMINAL SHIELD (YELLOW)	65114901		•	•	•	•																

